



**General:**

- Materials: PVC-U / PP
- Strainer: PP
- Sealing materials: EPDM / FPM
- Dimensions: DN10 – DN80  
d16 – d110  
3/8" – 4"

**End connections:**

- Solvent sockets PVC DIN / ASTM / JIS
- Solvent spigots PVC DIN
- Threaded sockets PVC / PP BSP
- Fusion sockets PP DIN
- Fusion spigots PP / PE DIN

**Operating pressure:**

DN10 d16 d3/8" – DN50 d63 2"	PN16/10
DN65 d75 d2 1/2"	PN16/8
DN80 d90 d3"	PN10/6
DN80 d110 d4"	PN6

**Features:**

- corrosion resistant
- radial installation or removal
- low pressure loss
- suitable for high flow rates
- quick and exact closing and opening
- suitable for liquids with very low specific gravity

This print contains no warranty promise, but it should give you some first information. The product range is extended continuously, therefore the versions and types correspond to the actual status of printing. Subject to technical modifications!



# Footvalve S4



## Dimensions:

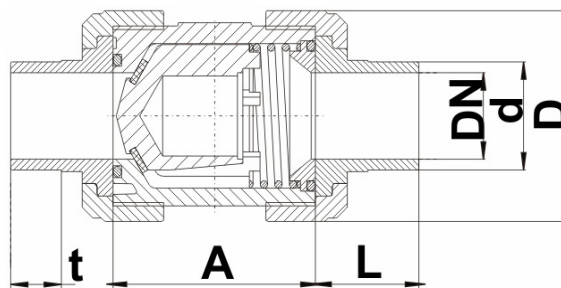
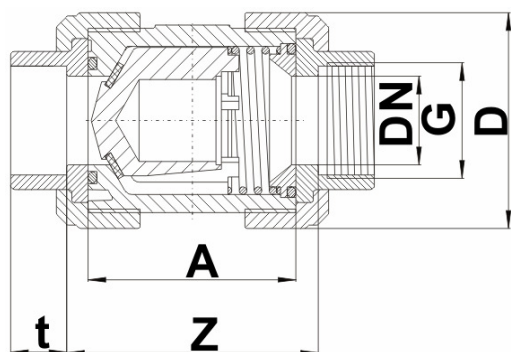

**Tip:**

The section drawings may not reflect the actual construction of a foot valve. They serve only for the dimensional representation of the connection options.

**PVC**

**End connections:**

PVC Solvent sockets / Solvent spigots / Threaded sockets  
PE Fusion spigots

DN	10	15	20	25	32	40	50	65	80	80
d	16	20	25	32	40	50	63	75	90	110
G <sup>1</sup> <sub>GM</sub>	3/8"	1/2"	3/4"	1"	1 1/4"	1 1/2"	2"	2 1/2"	3"	-
A	62	62	70	74	84	95	109	137	163	163
D	53	53	63	70	85	101	124,5	155	188	188
t <sup>2</sup> <sub>KM</sub>	16,5	16,5	19,5	22,5	26,5	31,5	38,5	45	55,5	64
t <sup>3</sup> <sub>KS</sub>	17	17	20	22,5	26,5	31,5	38,5	45	52	64,5
t <sup>4</sup> <sub>SS PE</sub>	13	14,5	15,5	18,5	15,5	29	31	32	30	38
L <sup>3</sup> <sub>KS</sub>	26,5	31,3	37,5	40,1	45	49,4	57,2	75,1	68,4	89
L <sup>4</sup> <sub>SS PE</sub>	25,1	30,4	36,5	38,6	29,1	42,3	44	57,8	65	80
Z <sup>1</sup> <sub>GM</sub>	67	67	77	81	90	104	120	150	185	-
Z <sup>2</sup> <sub>KM</sub>	68	67	76	80	91	103	120	148	180	173
PN	16	16	16	16	16	16	16	16	10	6

Dimensions in mm

<sup>1</sup>GM = Threaded sockets

<sup>2</sup>KM = Solvent sockets

<sup>5</sup>SS=Fusion spigots

<sup>3</sup>KS = Solvent spigots

- = Not implemented



# Footvalve S4

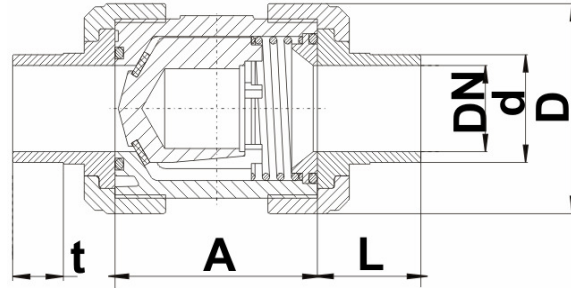
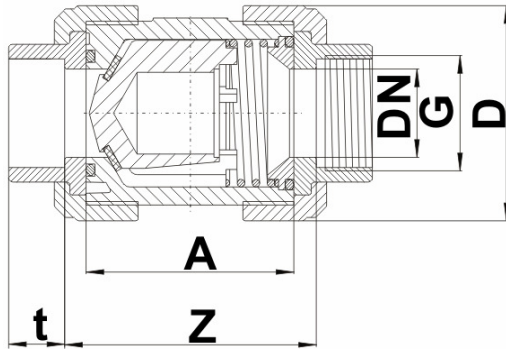

**Tip:**

The section drawings may not reflect the actual construction of a foot valve. They serve only for the dimensional representation of the connection options.

**PP**

**End connections**

PP Fusion sockets / Threaded sockets / Fusion spigots

DN	10	15	20	25	32	40	50	65	80	80
d	16	20	25	32	40	50	63	75	90	110
G <sup>GM 1</sup>	3/8"	1/2"	3/4"	1"	1 1/4"	1 1/2"	2"	2 1/2"	3"	-
A	62	62	69	73	93	94	108	133	160	160
D	53	53	64	71	84,5	100	120,5	155	187	187
t <sup>SM 2</sup>	16,5	16,5	19,5	22,5	26,5	31,5	38,5	45	55,5	64
t <sup>SS 3</sup>	13	14	15,5	18,5	20,5	23,5	28	31	36	38
t <sup>SS 3</sup>	26,2	30,9	37	39,4	44	48,5	55,8	72	67,5	76
Z <sup>GM 1</sup>	67	67	74	80	99	13	119	143	180	-
Z <sup>SM 2</sup>	71	68	78	84	107	113	136	162	211	213
PN	10	10	10	10	10	10	10	8	6	6

Dimensions in mm

<sup>1</sup>GM = Threaded sockets  
- = Not implemented

<sup>2</sup>SM = Fusion sockets

<sup>3</sup>SS = Fusion spigots



## Exploded drawing:

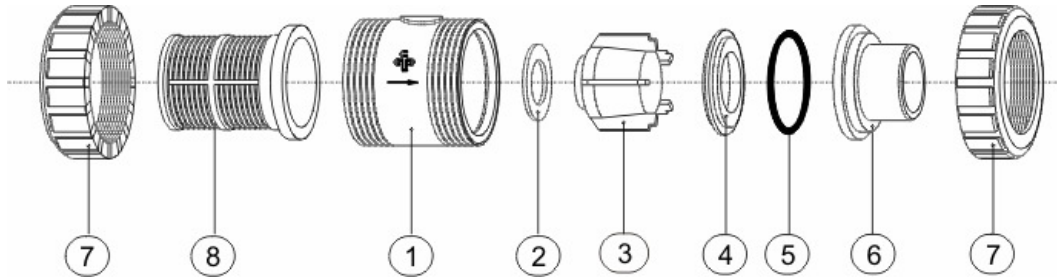

- 01. Body
- 02. Flat gasket
- 03. Cone
- 04. Trust collar
- 05. O-Ring
- 06. End connection
  - Threaded socket
  - Solvent socket
  - Solvent spigot
  - Fusion socket
  - Fusion spigot
- 07. Union
- 08. Strainer